

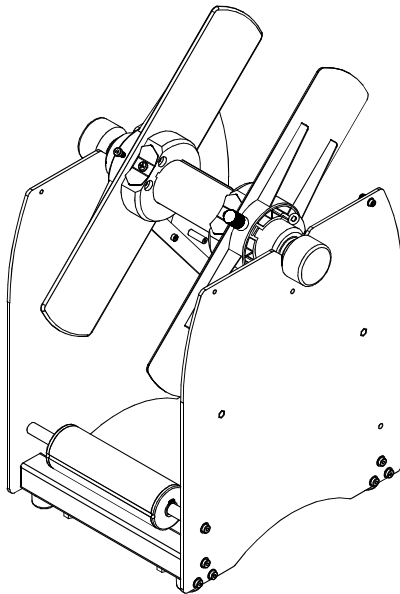

External Unwinder EU4

for Transfer Printer
BP-PR PLUS Series

Operator's Manual



Product Description

The **External Unwinder EU4** is a peripheral device for printers of different manufacturers. To handle large print jobs the external unwinder is available, it allows you to unwind complete rolls of label material. For a correct alignment of the **External Unwinder** with the printers of the BP-PR PLUS Series an Adapter Kit is offered.

Technical Specifications

| | |
|------------------------|--|
| Label Width | up to 4.7 in (120 mm) |
| Unwind Diameter | max. 11.7 in (300 mm) |
| Core Diameter | 1.56 in (40 mm) on cardboard core 3 in (76 mm) on cardboard core with adapter |
| Label Winding | Labels inside or outside |
| Dimensions | Height : 17.5 in (450 mm) Width : 10 in (260 mm) Depth : 11.7 in (300 mm) |
| Weight | 8.8 lb. (4 kg) |
| Option | Adapter Kit |

Safety Instructions



CAUTION !

During operation, the rotating rewinder axle, with the flange mounted upon it, is freely accessible.
The operator must ensure that loose hanging jewellery, hair etc. are kept clear of the moving parts.
Risk of injury from moving parts !

Delivery Contents



NOTICE !
Retain packing material for later use !

1 - Unwinder

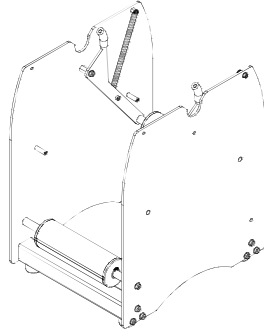

2 - Winding Axle

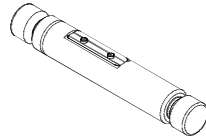

3 - 2 Flanges

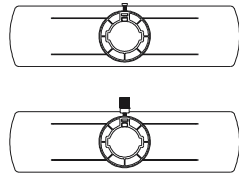

4 - 2 Winding Adapters

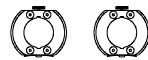

5 - 8 Screws



6 - Operator's Manual



Fig. 1 Delivery contents

Placing the Unwinder

When you switch between outside and inside wound materials you have to turn the unwinder 180 degrees. Compare for this in the two following figures the position of the swing arm (7).

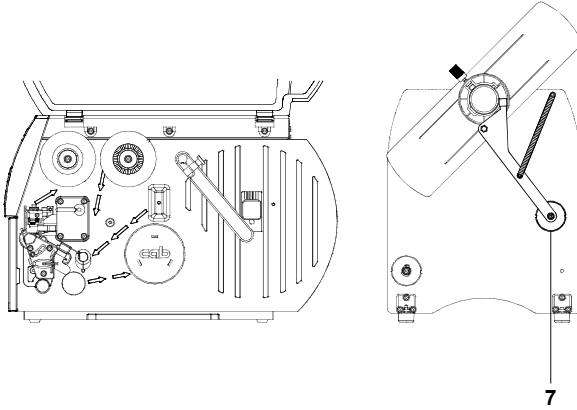

Fig. 2 Placing the unwinder for outside wound labels

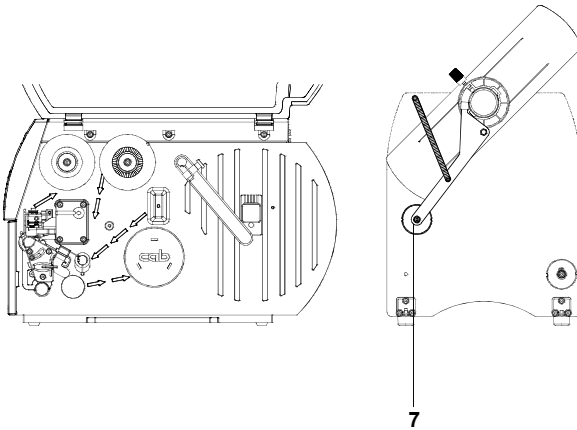

Fig. 3 Placing the unwinder for inside wound labels

Media Loading

The mounting steps are depending on the cardboard core of the chosen material roll. Possible cardboard cores are 1.56 in (40 mm) and 3 in (76 mm). At first you have to prepare the flanges and the winding axle in dependence to the cardboard core:

Preparing the Winding Axle and the Flanges

There is a spring (8) mounted on the winding axle (2) to guarantee a properly stability of the unwinding material when using rolls with a 1.56 in (40 mm) cardboard core.

When unwinding from rolls with a 3 in (76 mm) cardboard core this spring has to be removed. For this you have to loosen the two screws (9).

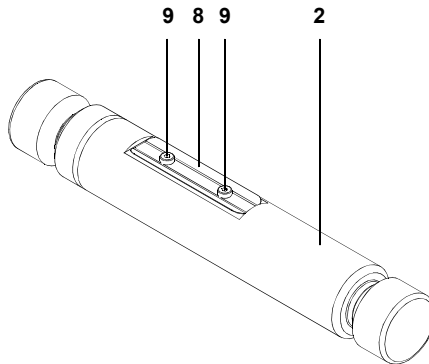

Fig. 4 Preparing the winding axle

When using material rolls with 3 in (76 mm) cardboard core a winding adapter (4) has to be fixed on each of the two flanges (3) for a properly stability of the roll. Fix the winding adapters (4) on the flanges (3) by using the screws (5) included in the delivery content.

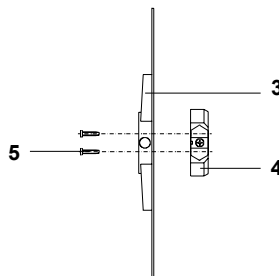

Fig. 5 Preparing the flanges

Loading Rolls with 1.56 in (40 mm) Cardboard Core on the Winding Axle

Before mounting the winding axle read this chapter and "Insertion of the prepared Winding Axle" and attend on the running of the media in dependence to inside and outside wound label rolls.



NOTICE !

For rolls with 1.56 in (40 mm) cardboard core you have to dismount the winding adapters from the flanges. The spring has to be mounted on the winding axle (see "Preparing the Winding Axle and the Flanges").

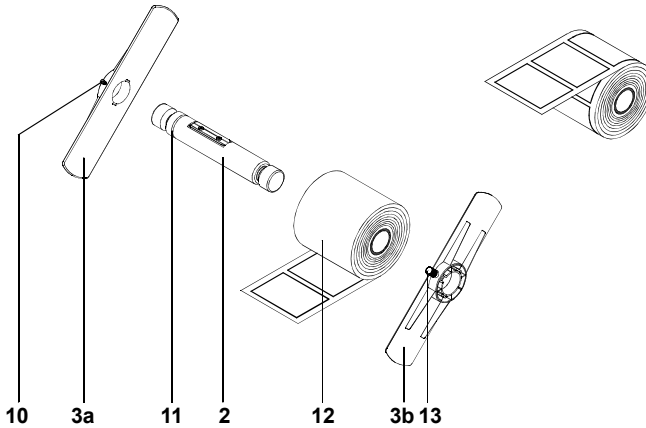

Fig. 6 Mounting the winding axle

- Slide the flange (3a) on the winding axle (2) so that the attachment of the flange points to the outside.
- Align the flange (3a) so that the screw (10) grasps into the groove (11) of the winding axle (2). Tighten the screw (10) in the flange.
- Slide the material roll (12) onto the axle until it touches the flange slightly.
- Push the second flange (3b) with the attachment outside onto the axle until it touches the material roll.



NOTICE !

If the material roll is smaller than the spring on the axle, pay attention that the spring on the axle is guided in the groove of the flange (3b) !

- Tighten the knurled screw (13) in the flange (3b).
- Align flange (3a) to flange (3b)!

Continue with the chapter "Insertion of the prepared Winding Axle".

Loading Rolls with 3 in (76 mm) Cardboard Core on the Winding Axle

Before mounting the winding axle read this chapter and "Insertion of the prepared Winding Axle" and attend on the running of the media in dependence to inside and outside wound label rolls.



NOTICE !

For rolls with 3 in (76 mm) cardboard core you have to mount the winding adapter on the flanges and remove the spring from the winding axle as described in "Preparing the Winding Axle and the Flanges".

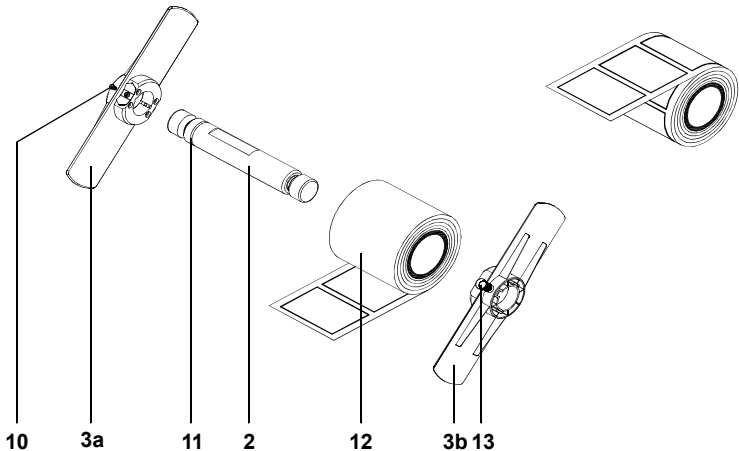

Fig. 7 Mounting the winding axle

- Slide the flange (3a) on the winding axle (2) so that the attachment of the flange points to the outside.
- Align the flange (3a) so that the screw (10) grasps into the groove (11) of the winding axle (2). Tighten the screw (10) in the flange.
- Slide the material roll (12) onto the axle until it touches the flange slightly.
- Push the second flange (3b) with the attachment outside onto the axle until it touches the material roll. The cardboard core of the material roll has to be positioned on the winding adapters.
- Tighten the knurled screw (13) in the flange (3b).

Continue with the chapter "Insertion of the prepared Winding Axle".

Insertion of the Prepared Winding Axle



NOTICE !

Attend on the different positions of the Unwinder. The position depends on the wounding of the material rolls as described in chapter "Placing the Unwinder".

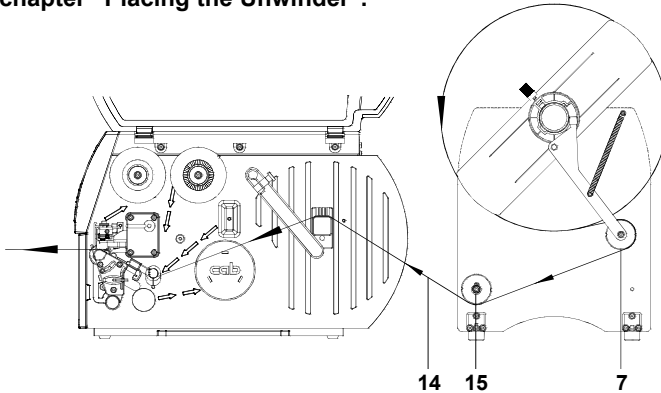

Fig. 8 Unwinding from a roll with outside wound labels

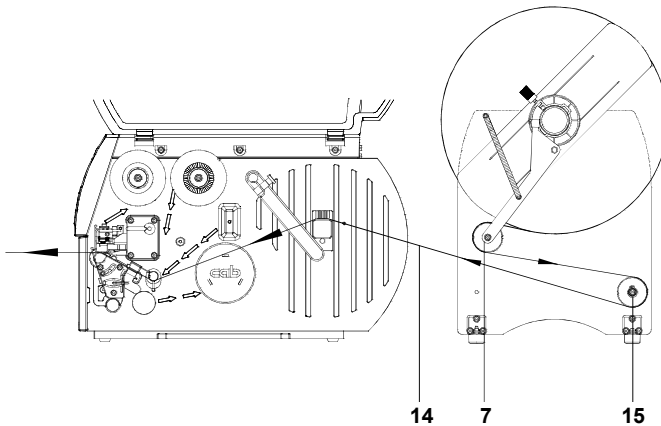

Fig. 9 Unwinding from a roll with inside wound labels

- Hang up the axle with material in the unwinder. When hanging up, the flange with the knurled screw has to be in front.
- Feed the label strip (14) over the swing arm (7) and the rewind axle (15) to the printer.
- Insert the material according to the instructions of the printers operator`s manual.
- Align the unwinder to the printer (see "Adjusting the Unwinder")

Adjusting the Unwinder

To avoid crinkling in the material running the unwinder has to be aligned exactly to the printer.

For a trouble-free adjustment of the unwinder to a printer of the BP-PR PLUS Series an adapter kit is offered.

The unwinder is correctly aligned, when the edge of the material at the printers chassis (**A**) is in line with the material-sided edge of the flange (**B**):

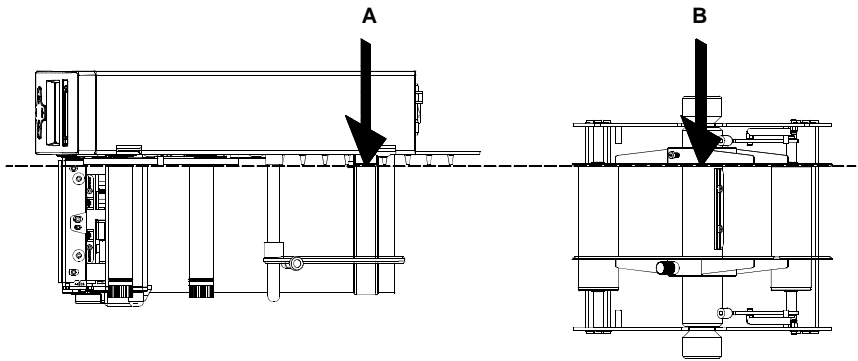

Fig. 10 Adjusting the unwinder

BRADY



W.H. Brady
Lindestraat 21
Industriepark C3
9240 Zele Belgium
Tel.: +32 52 457 811
e-mail: support@brady.be

BRADY



Identification Solutions Division
6555 W. Good Hope Road
PO Box 2131
Milwaukee, WI 53201 U.S.A.
Phone: 1-800-537-8791
Fax: 1-800-292-2289

All specifications about delivery, design, performance and weight are given to the best of our current knowledge and are subject to change without prior notice.